

IMPORTANT NOTE:

- 2 - MINIMUM 1.5 CALIPER INCH MEDIUM CANOPY SHADE TREES TO BE PLANTED PER LOT. ALL TREES ARE REQUIRED TO BE MEDIUM TO LARGE CANOPY TREES. A MEDIUM TO LARGE CANOPY TREE IS DESIGNATED IN CITY OF SAN ANTONIO UNIFIED DEVELOPMENT CODE APPENDIX E.
- DISTURBED AREAS WILL BE RECLAIMED BY DRILL SEEDING WITH A NATIVE SEED MIX AND ENSURING 85% ESTABLISHMENT.

CONTRACTOR NOTE:

THE CONTRACTOR SHALL BE RESPONSIBLE TO SCHEDULE A PRE CONSTRUCTION MEETING PRIOR TO SITE DEVELOPMENT TO STAY IN COMPLIANCE WITH THE UNIFIED DEVELOPMENT CODE SECTION 35-477 (b) (c), WHICH STATES A PRE CONSTRUCTION MEETING IS REQUIRED TO REVIEW PROCEDURES FOR PROTECTION AND MANAGEMENT OF ALL SIGNIFICANT, HERITAGE OR MITIGATION TREES. THIS CAN BE SCHEDULED WITH FENCING INSPECTION, 207-1111. REFERENCE AP # 22-38800910

GRADING PLAN NOTE:

A GRADING PLAN SHALL BE SUBMITTED AT PLATTING STAGE FOR UNIT 2 TO VERIFY COMPLIANCE WITH APPROVED TREE PRESERVATION PLAN. APPROVED TREE PLAN SHALL BE AMENDED AT PLATTING STAGE TO SHOW EXISTING AND PROPOSED GRADING FOR UNIT TO BE PLATTED.

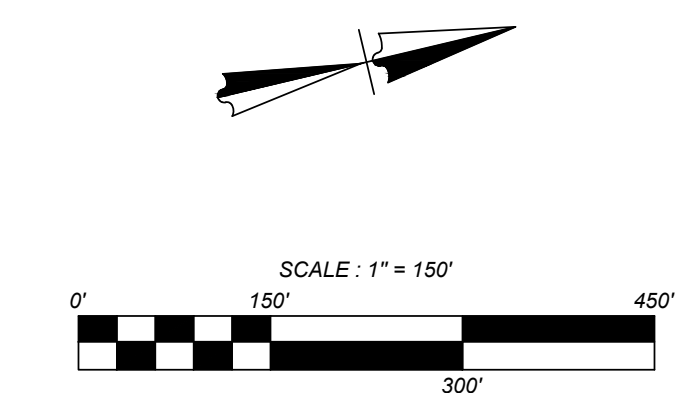
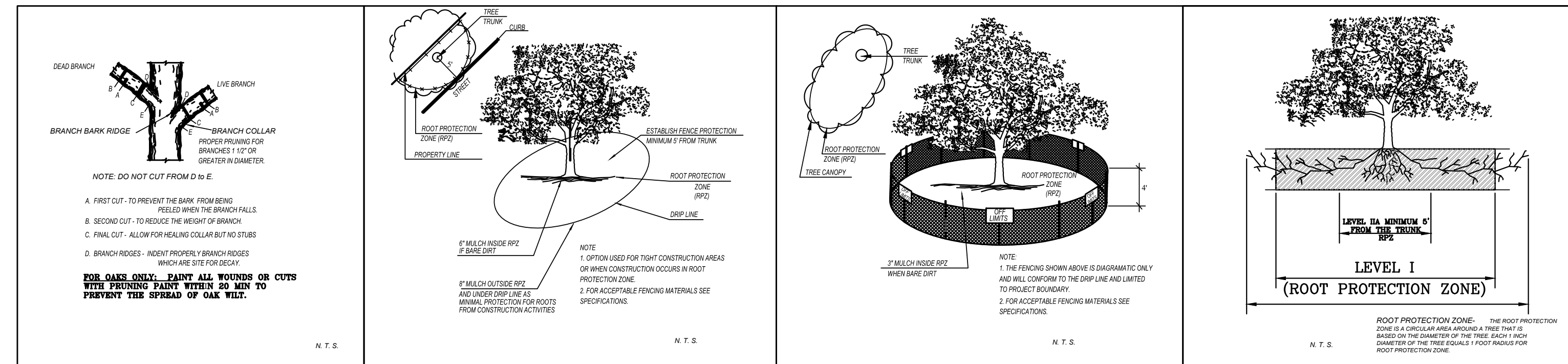

LEGEND

- REMOVED
- PRESERVED
- EXEMPT
- PRESERVED - FEMA
- REMOVED - RIPARIAN BUFFER
- PRESERVED - RIPARIAN BUFFER
- REMOVED - FEMA
- PROJECT LIMITS
- PROPOSED 100-YR FLOODPLAIN LIMITS
- 30' RIPARIAN BUFFER

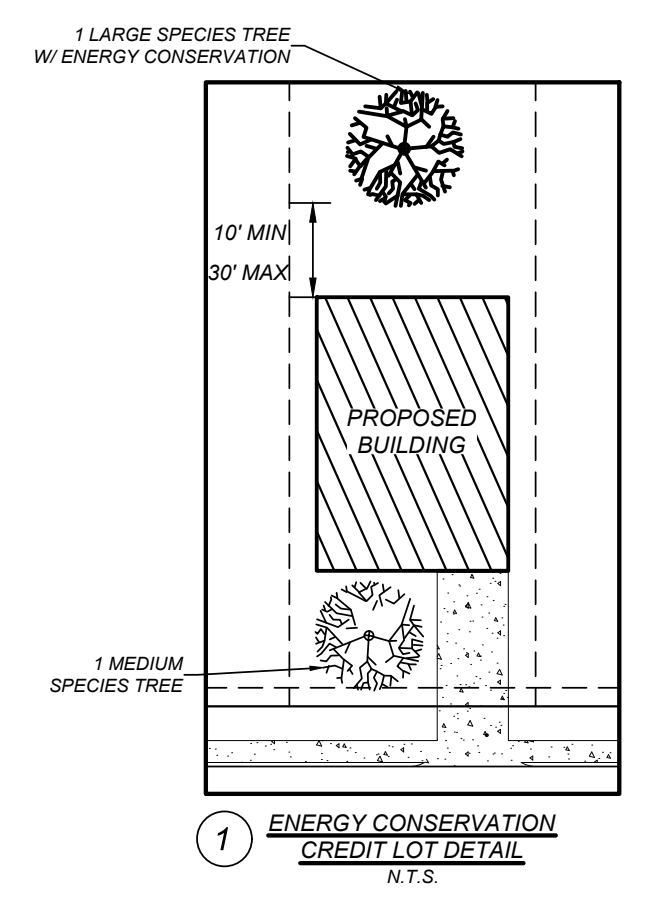
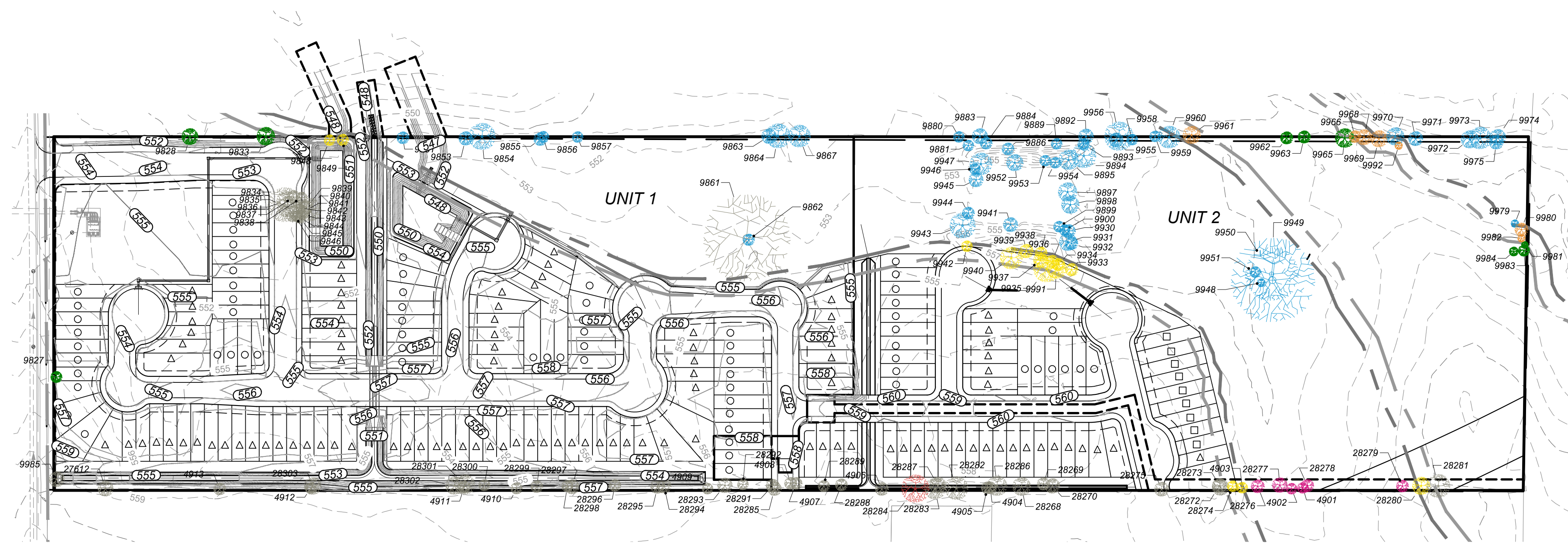

1 LOT NUMBERS WITH CIRCLES SHALL HAVE ONE (1) MEDIUM SPECIES TREE PLANTED IN THE FRONT YARD, ONE (1) LARGE SPECIES TREE IN THE BACK YARD WITHIN THE ENERGY CONSERVATION LIMITS. SEE DETAIL THIS SHEET

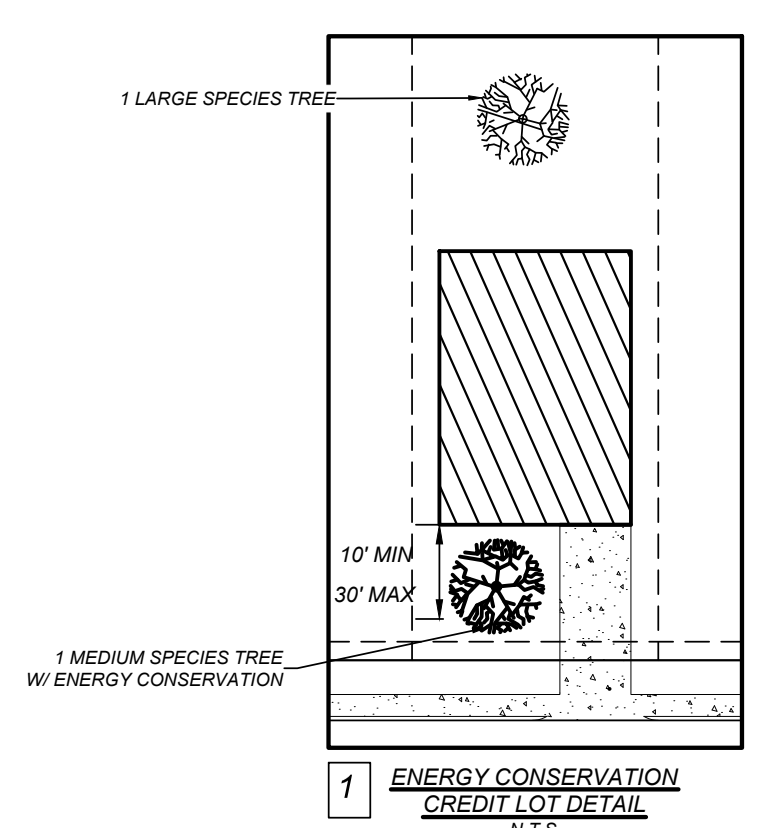

1 LOT NUMBERS WITH SQUARES SHALL HAVE ONE (1) MEDIUM SPECIES TREE IN THE FRONT YARD WITHIN THE ENERGY CONSERVATION LIMITS, ONE (1) LARGE SPECIES TREE IN THE BACK YARD.

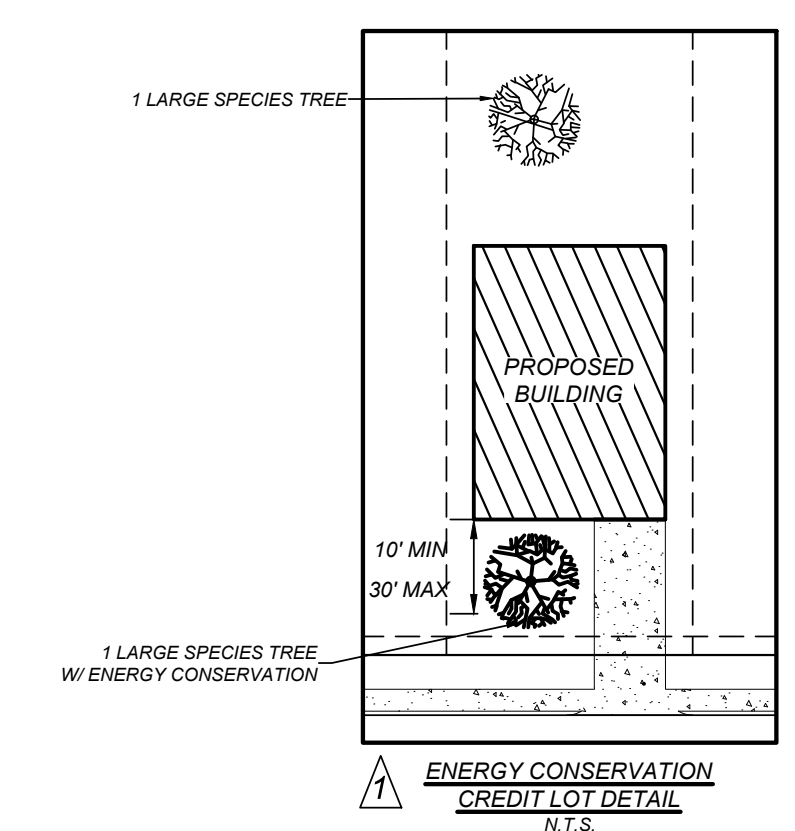

1 LOT NUMBERS WITH TRIANGLES SHALL HAVE ONE (1) LARGE SPECIES TREE PLANTED IN THE FRONT YARD WITHIN THE ENERGY CONSERVATION LIMITS, ONE (1) LARGE SPECIES TREE IN THE BACK YARD. SEE DETAIL THIS SHEET

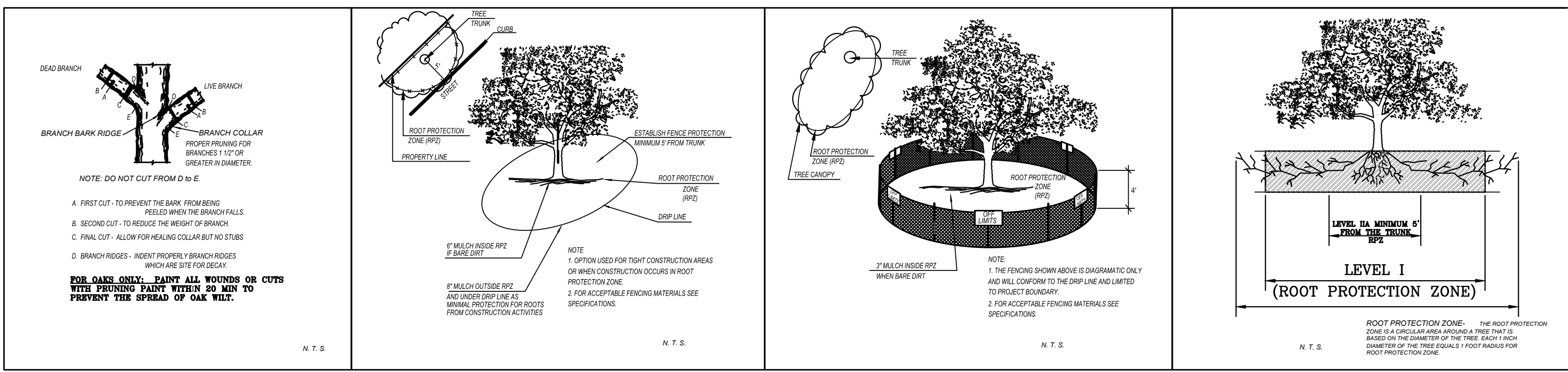

IMPORTANT NOTE:

- 2 - MINIMUM - 1 5 CALIPER INCH MEDIUM CANOPY SHADE TREES TO BE PLANTED PER LOT. ALL TREES ARE REQUIRED TO BE MEDIUM TO LARGE CANOPY TREES. A MEDIUM TO LARGE CANOPY TREE IS DESIGNATED IN CITY OF SAN ANTONIO UNIFIED DEVELOPMENT CODE APPENDIX E.
- DISTURBED AREAS WILL BE RECLAIMED BY DRILL SEEDING WITH A NATIVE SEED MIX AND ENSURING 85% ESTABLISHMENT.

CONTRACTOR NOTE:

THE CONTRACTOR SHALL BE RESPONSIBLE TO SCHEDULE A PRE CONSTRUCTION MEETING PRIOR TO SITE DEVELOPMENT TO STAY IN COMPLIANCE WITH THE UNIFIED DEVELOPMENT CODE SECTION 35-477 (B) (C), WHICH STATES A PRE CONSTRUCTION MEETING IS REQUIRED TO REVIEW PROCEDURES FOR PROTECTION AND MANAGEMENT OF ALL SIGNIFICANT, HERITAGE OR MITIGATION TREES. THIS CAN BE SCHEDULED WITH FENCING INSPECTION, 207-1111. REFERENCE AP # 23-38809910

GRADING PLAN NOTE:

A GRADING PLAN SHALL BE SUBMITTED AT PLATTING STAGE FOR UNIT 2 TO VERIFY COMPLIANCE WITH APPROVED TREE PRESERVATION PLAN. APPROVED TREE PLAN SHALL BE AMENDED AT PLATTING STAGE TO SHOW EXISTING AND PROPOSED GRADING FOR UNIT TO BE PLATTED.

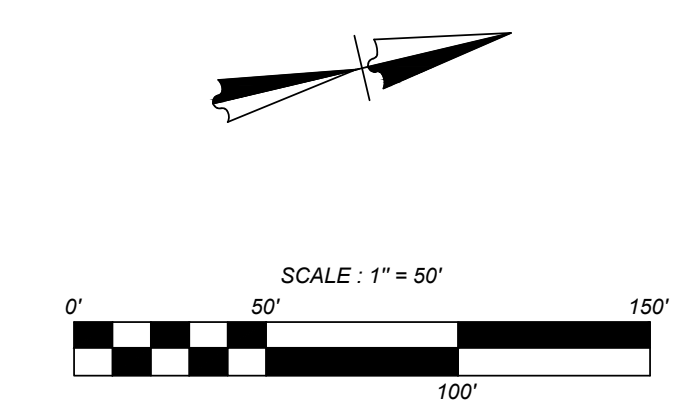

LOCATION MAP
N.T.S.

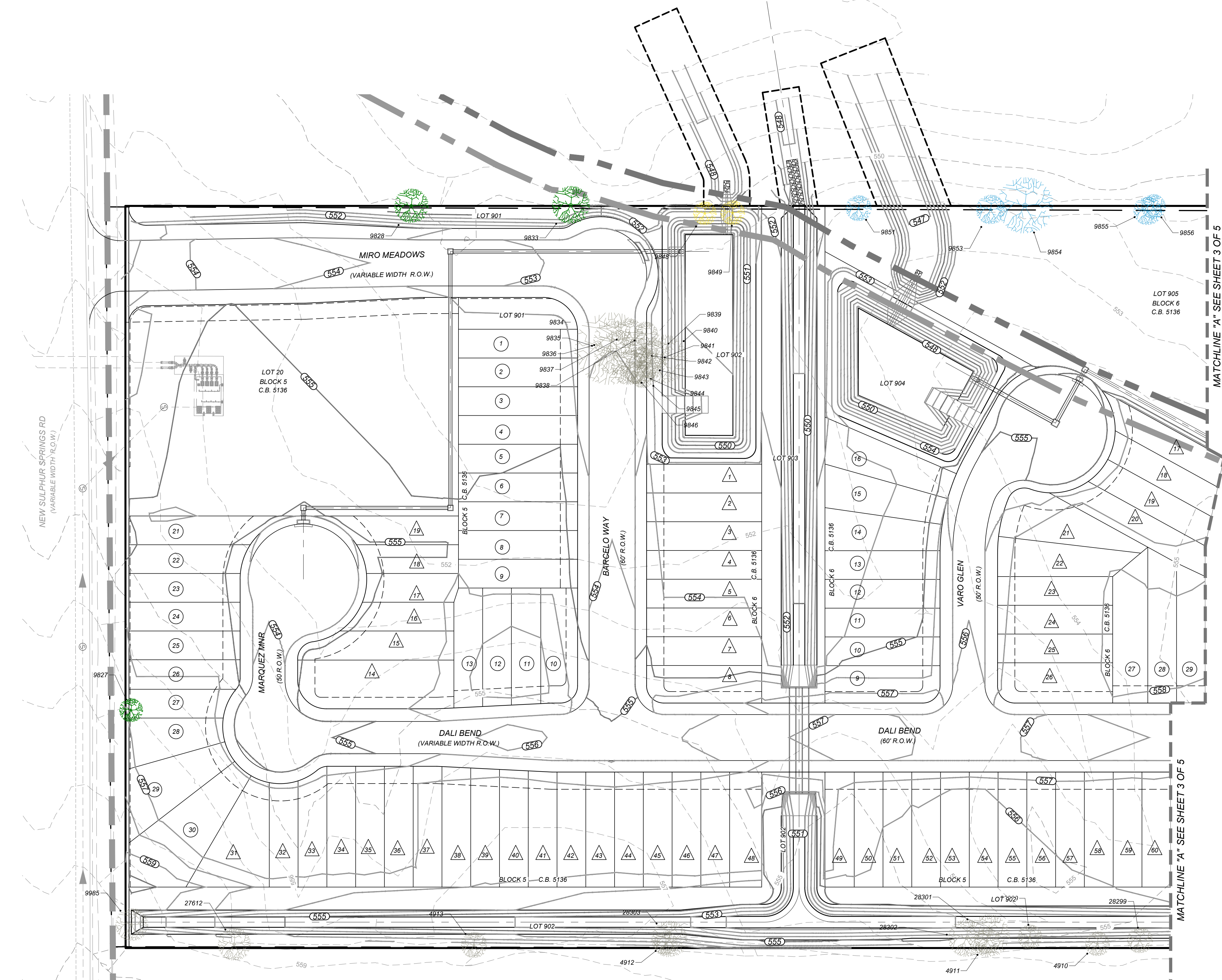

LEGEND

- REMOVED
- PRESERVED
- EXEMPT
- PRESERVED - FEMA
- REMOVED - RIPARIAN BUFFER
- PRESERVED - RIPARIAN BUFFER
- REMOVED - FEMA

- PROJECT LIMITS
- PROPOSED 100-YR FLOODPLAIN LIMITS
- 30' RIPARIAN BUFFER

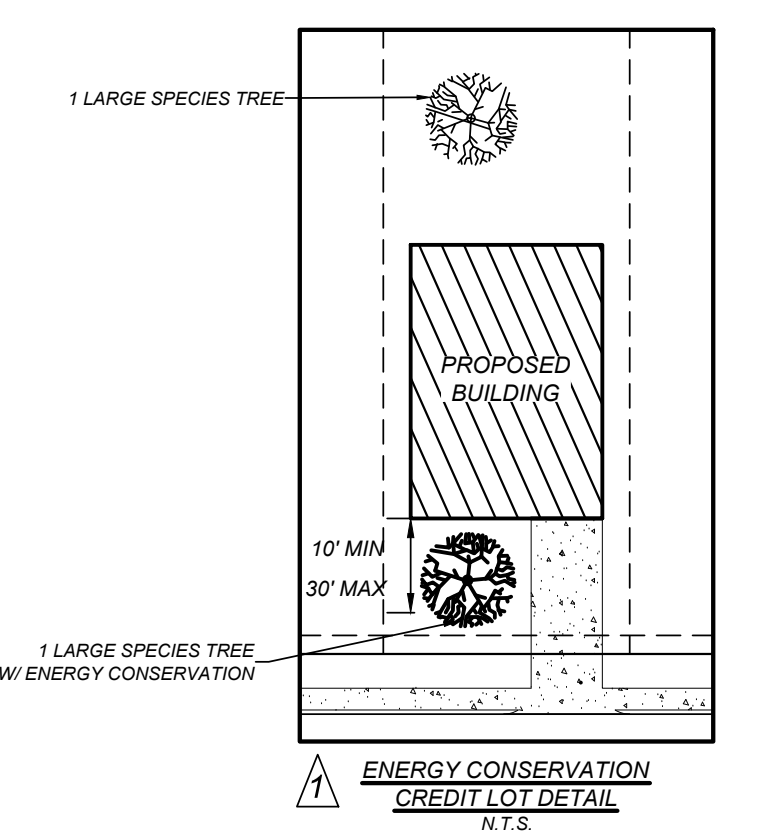
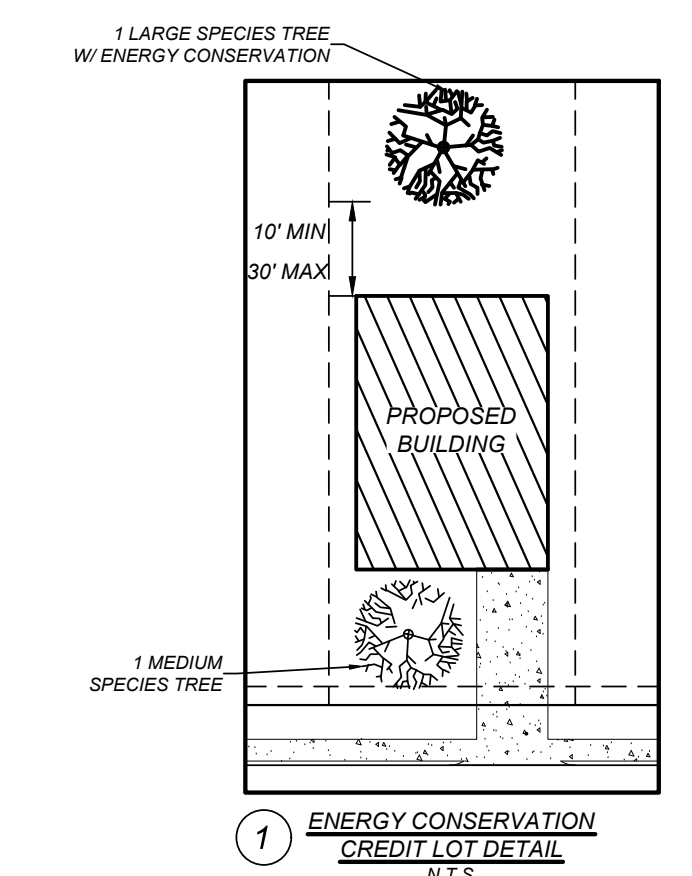
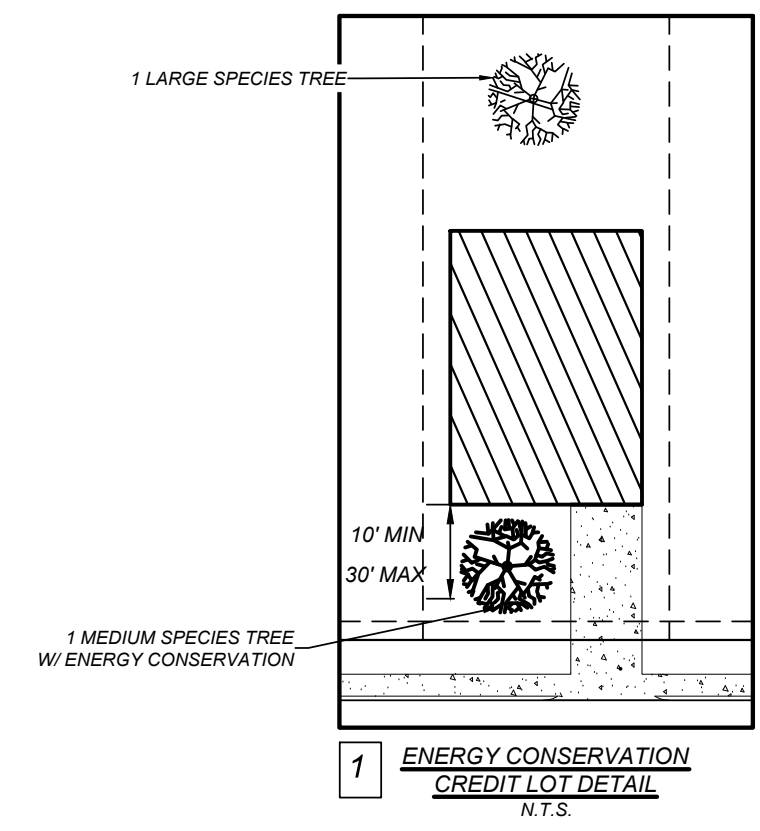

IMPORTANT NOTE:

- 2" MINIMUM - 1.5 CALIPER INCH MEDIUM CANOPY SHADE TREES TO BE PLANTED PER LOT. ALL TREES ARE REQUIRED TO BE MEDIUM TO LARGE CANOPY TREES. A MEDIUM TO LARGE CANOPY TREE IS DESIGNATED IN CITY OF SAN ANTONIO UNIFIED DEVELOPMENT CODE APPENDIX E.
- DISTURBED AREAS WILL BE RECLAIMED BY DRILL SEEDING WITH A NATIVE SEED MIX AND ENSURING 85% ESTABLISHMENT.

CONTRACTOR NOTE:

THE CONTRACTOR SHALL BE RESPONSIBLE TO SCHEDULE A PRE CONSTRUCTION MEETING PRIOR TO SITE DEVELOPMENT TO STAY IN COMPLIANCE WITH THE UNIFIED DEVELOPMENT CODE SECTION 35-477 (5) (C), WHICH STATES A PRE CONSTRUCTION MEETING IS REQUIRED TO REVIEW PROCEDURES FOR PROTECTION AND MANAGEMENT OF ALL SIGNIFICANT, HERITAGE OR MITIGATION TREES. THIS CAN BE SCHEDULED WITH FENCING INSPECTION, 207-1111. REFERENCE AP # 22-38800910

GRADING PLAN NOTE:

A GRADING PLAN SHALL BE SUBMITTED AT PLATTING STAGE FOR UNIT 2 TO VERIFY COMPLIANCE WITH APPROVED TREE PRESERVATION PLAN. APPROVED TREE PLAN SHALL BE AMENDED AT PLATTING STAGE TO SHOW EXISTING AND PROPOSED GRADING FOR UNIT TO BE PLATTED.

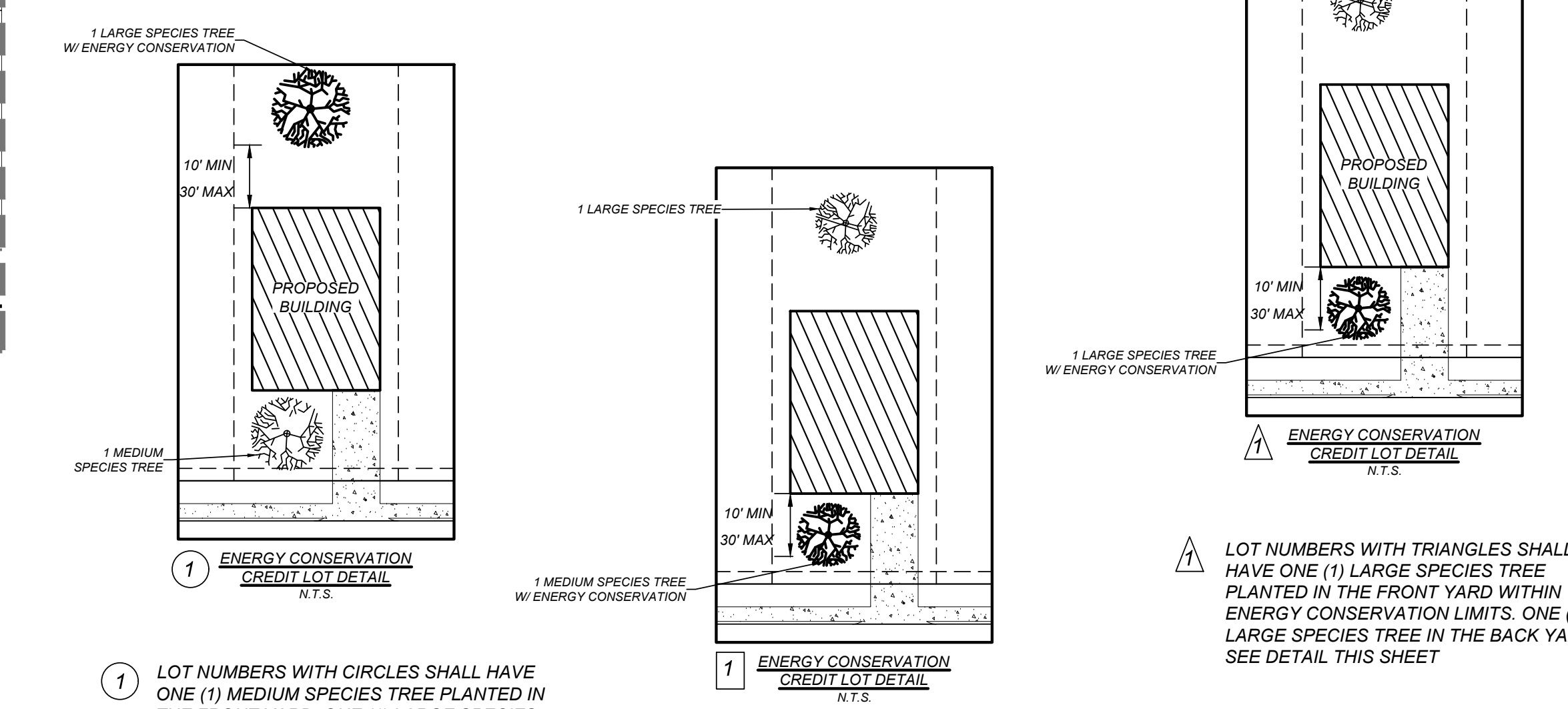
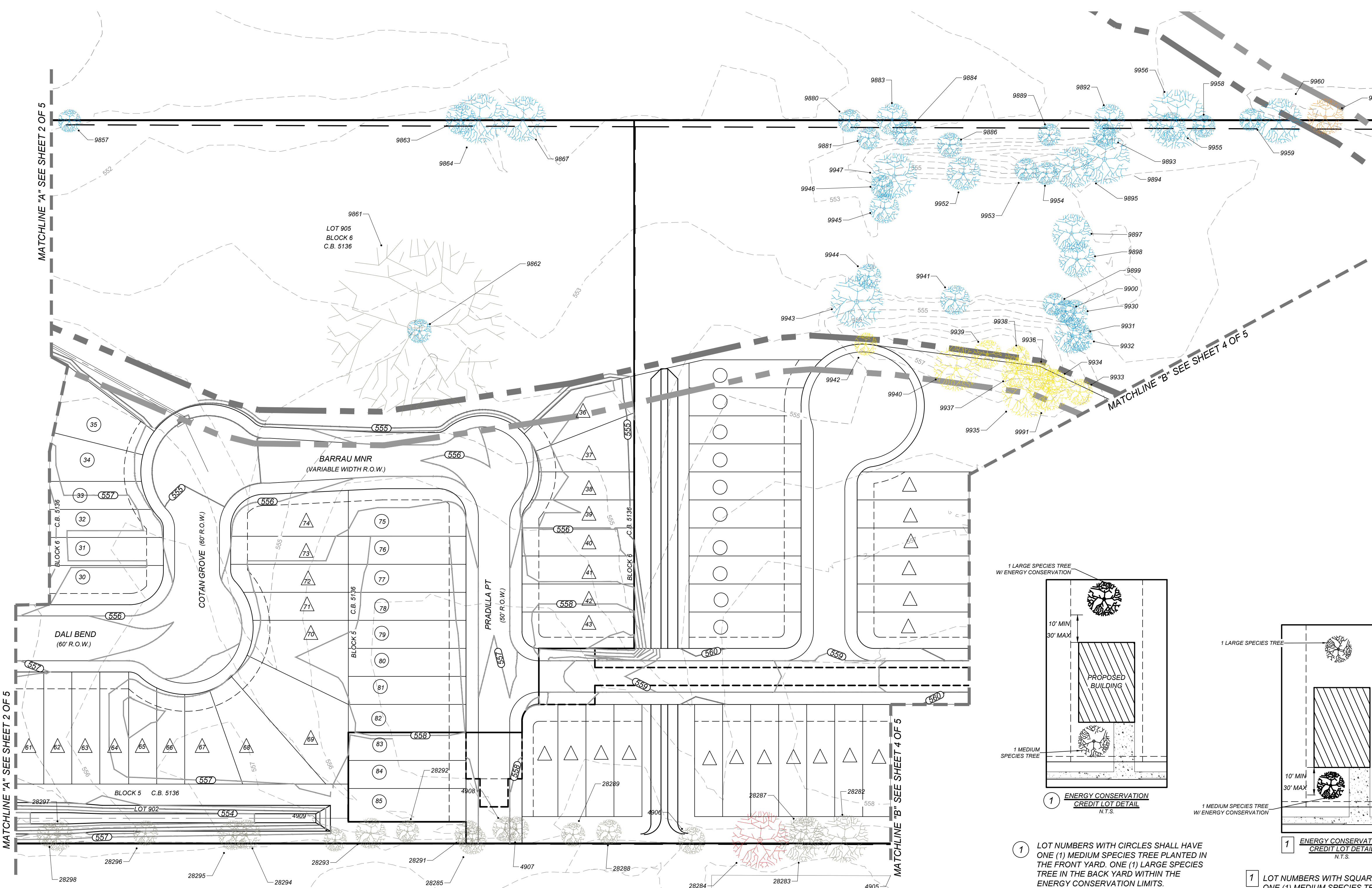
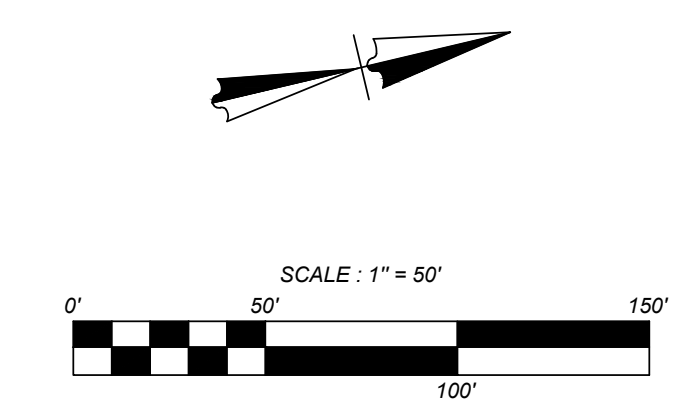
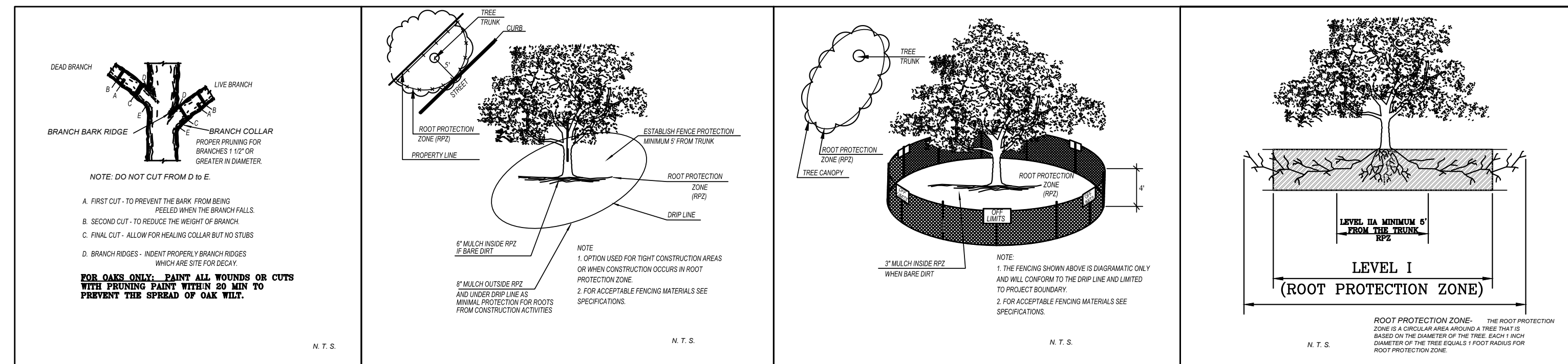

Date: Mar 27, 2023, 2:17pm User ID: rhouse
 File: N:\314\46\02\Design\GMI\TREES\TPS3144602_REDESIGN_UPDATE_D1.dwg

KIEWIT
ENGINEERS + SURVEYING
 16251
 Phone # (210) 878-8444 • Fax # (210) 878-8441
 TBPE Firm #: 9513 • TBPE S Firm #: 1012300

MIRO MEADOWS
 BEXAR COUNTY, TEXAS

TREE PRESERVATION PLAN

PLAT NO.
22-1800054

JOB NO: 314-46-02
 DATE: JUNE 2022
 DRAWN: RH CHECKED: JM

SHEET NUMBER:
3 OF 5

IMPORTANT NOTE:

- 2 - MINIMUM 1.5 CALIPER INCH MEDIUM CANOPY SHADE TREES TO BE PLANTED PER LOT. ALL TREES ARE REQUIRED TO BE MEDIUM TO LARGE CANOPY TREES. A MEDIUM TO LARGE CANOPY TREE IS DESIGNATED IN CITY OF SAN ANTONIO UNIFIED DEVELOPMENT CODE APPENDIX E.
- DISTURBED AREAS WILL BE RECLAIMED BY DRILL SEEDING WITH A NATIVE SEED MIX AND ENSURING 85% ESTABLISHMENT.

CONTRACTOR NOTE:

THE CONTRACTOR SHALL BE RESPONSIBLE TO SCHEDULE A PRE CONSTRUCTION MEETING PRIOR TO SITE DEVELOPMENT TO STAY IN COMPLIANCE WITH THE UNIFIED DEVELOPMENT CODE SECTION 35-47 (b) (c), WHICH STATES A PRE CONSTRUCTION MEETING IS REQUIRED TO REVIEW PROCEDURES FOR PROTECTION AND MANAGEMENT OF ALL SIGNIFICANT, HERITAGE OR MITIGATION TREES. THIS CAN BE SCHEDULED WITH FENCING INSPECTION, 207-1111. REFERENCE AP # 22-3880010

GRADING PLAN NOTE:

A GRADING PLAN SHALL BE SUBMITTED AT PLATTING STAGE FOR UNITS 2, 3, 4 AND 5 TO VERIFY COMPLIANCE WITH APPROVED TREE PRESERVATION PLAN. APPROVED TREE PLAN SHALL BE AMENDED AT PLATTING STAGE TO SHOW EXISTING AND PROPOSED GRADING FOR UNIT TO BE PLATTED.

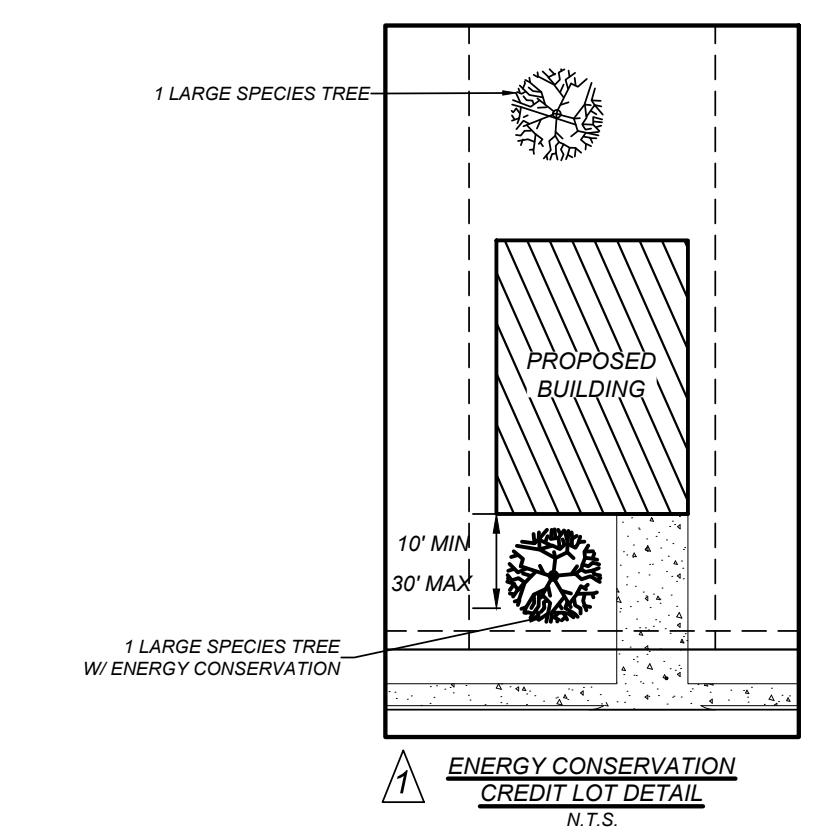
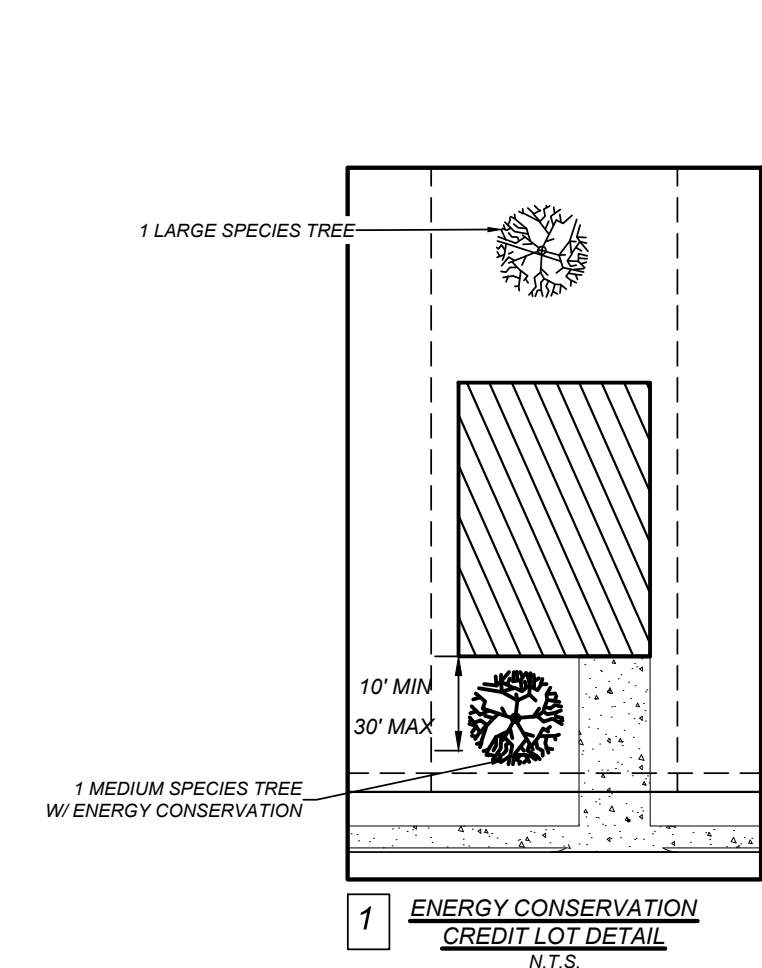
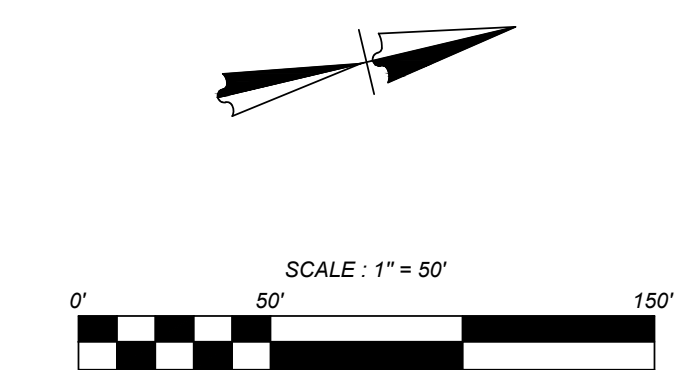
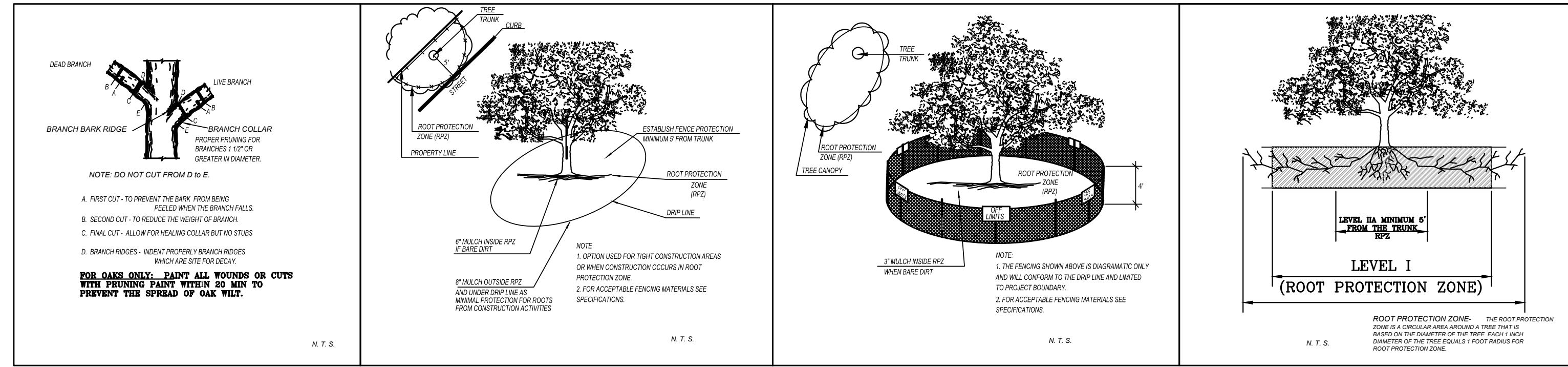

LOT NUMBERS WITH SQUARES SHALL HAVE ONE (1) MEDIUM SPECIES TREE IN THE FRONT YARD WITHIN THE ENERGY CONSERVATION LIMITS. ONE (1) LARGE SPECIES TREE IN THE BACK YARD.

LOT NUMBERS WITH TRIANGLES SHALL HAVE ONE (1) LARGE SPECIES TREE PLANTED IN THE FRONT YARD WITHIN THE ENERGY CONSERVATION LIMITS. ONE (1) LARGE SPECIES TREE IN THE BACK YARD. SEE DETAIL THIS SHEET

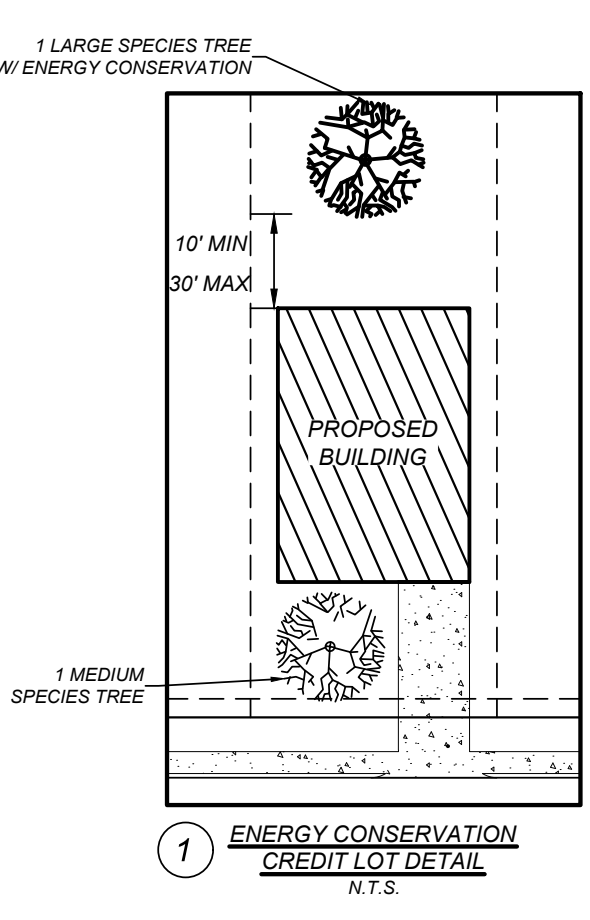

LOT NUMBERS WITH CIRCLES SHALL HAVE ONE (1) MEDIUM SPECIES TREE PLANTED IN THE FRONT YARD. ONE (1) LARGE SPECIES TREE IN THE BACK YARD WITHIN THE ENERGY CONSERVATION LIMITS. SEE DETAIL THIS SHEET

